

Industrial Style Rolling Shelf

Create big impact with this simple and versatile rolling shelf.

The possibilities are endless – from the kitchen as a drinks trolley, to the living room as a feature to display artefacts or even the home office to store all your stationary, files and crates.



Image Credit: Ana-White.com



1 The shelves, each 800mm long, are cut from shop bought 220mm wide x 44mm thick planks.

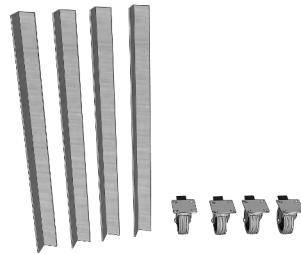

2 The shelf is held together by four 610mm lengths of 38mm wide x 3mm thick Angle Aluminium. And it runs on four castor wheels.



3 This is how the various components of the shelf go together. Distance between the shelves is 239mm.



4 On one side of the aluminium, drill 3.5mm holes in the centre & 15mm in from each end. On the adjacent side, offset the holes so that the screws don't bump into each other when screwed in.

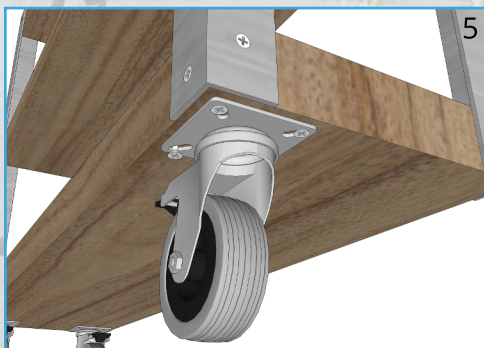

5 Secure the castors to the four corners of the underside of the bottom shelf. Don't place them directly on the edge – rather move them 10mm in from each side – otherwise the screws might breakout.



6 Fully assembled, your rolling shelf should look like this.